

MODEL TR – SQUARE TO ROUND TRANSITION, 1-1/8" NECK

1. GALVANIZED STEEL CONSTRUCTION
2. CONVERTS SQUARE NECK TO ROUND NECK
3. BOX IS 1-9/16" DEEP
4. ROUND NECK HEIGHT IS 1-1/8"
5. MILL (M) FINISH

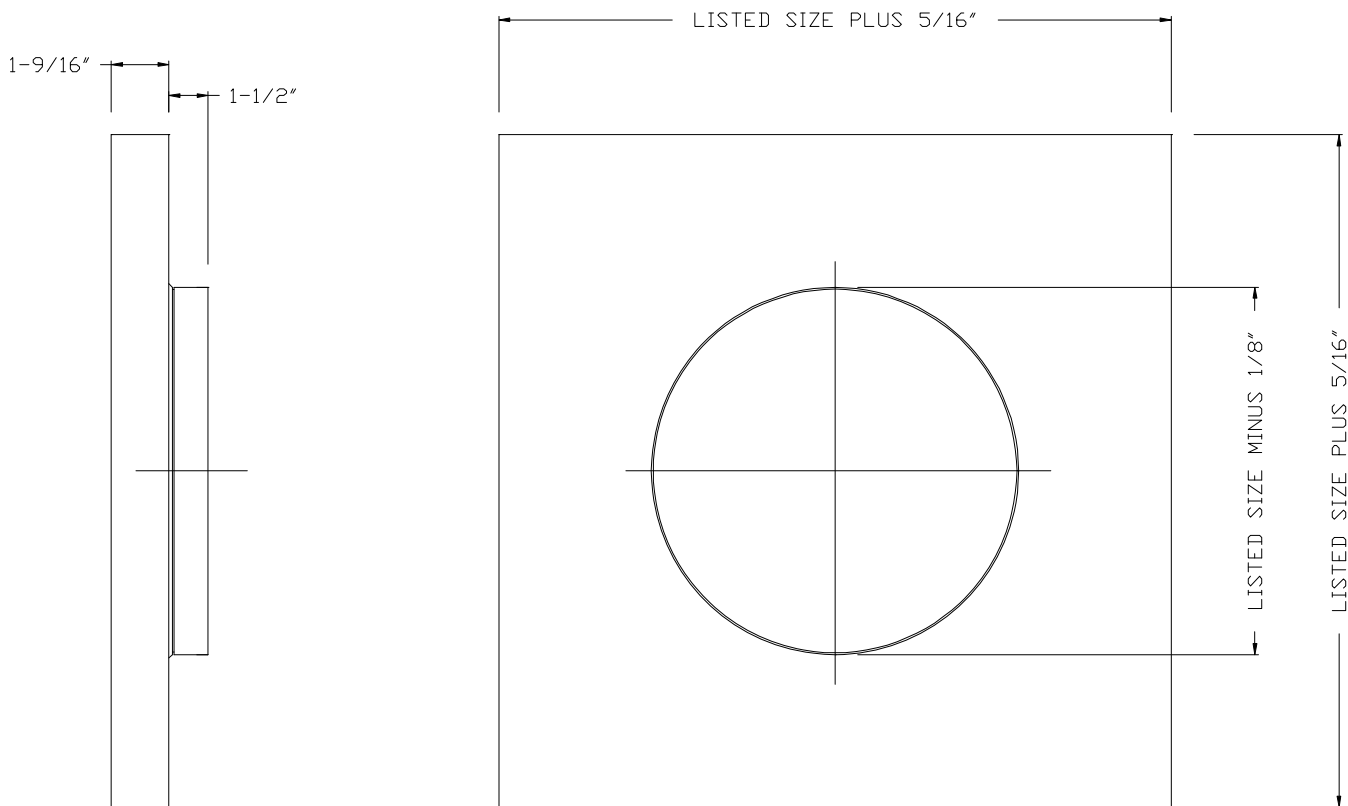

TR												
Square Neck Size	Round Duct Size											
	5"	6"	7"	8"	9"	10"	11"	12"	14"	15"	16"	18"
6"x6"	X	X										
8"x8"	X	X	X	X								
9"x9"	X	X	X	X	X							
10"x10"	X	X	X	X	X	X						
12"x12"	X	X	X	X	X	X	X	X				
14"x14"	X	X	X	X	X	X	X	X	X			
15"x15"	X	X	X	X	X	X	X	X	X	X		
16"x16"	X	X	X	X	X	X	X	X	X	X	X	
18"x18"	X	X	X	X	X	X	X	X	X	X	X	X